

Join Harbor Freight, Spry Senior,
Citizens Bank and more!

**HARBOR
FREIGHT**
Quality Tools at Ridiculously Low Prices



29,808 sf
Anchor
Opportunity

SPRY +
SENIOR



Google Maps

STRONGSVILLE TOWNE CENTER

FOR LEASE

ANCHOR SPACE AVAILABLE

15153 Pearl Rd./ Rt. 42

Strongsville, OH 44136

STRONGSVILLE TOWN CENTER

DiFranco Commercial Real Estate is pleased to present in association with Emmco Corporation a 129,163 SF retail center in the heart of Strongsville.



This property speaks for itself, but some features we love to include:

- Shopping center features **10 different food options**, which draws enormous daytime and evening traffic
- Centrally located in one of Cleveland's fastest-growing suburbs
- 1,600 local businesses with 25,000 local employees
- A traffic count of over 19,000 VPD at the Center's main traffic signal
- High school and post office within a quarter mile of our center
- Regional retail area with over 3.7 million sq ft retail space including South Park Center Mall, Costco, Best Buy, Bed Bath & Beyond, Heinen's, T.J.Maxx, Walmart, Home Depot, Target, Macy's, Dillard's, and a new Giant Eagle Market Place
- Less than two (2) miles from Interstate 71 and Ohio Turnpike
- Multiple Opportunities! 129,163 SF shopping center - inquire about current promotions!
- High-quality shopping center located between the regional hub of Southpark Mall, Strongsville High School, and Giant Eagle Market District

SHOPPING CENTER AERIAL

29,808 sf Anchor Opportunity



Shurmer Road
Access to 82, South Park Mall,
and I-71 in minutes

Pearl Rd.

22,702 VPD

Firestone



SITE PLAN

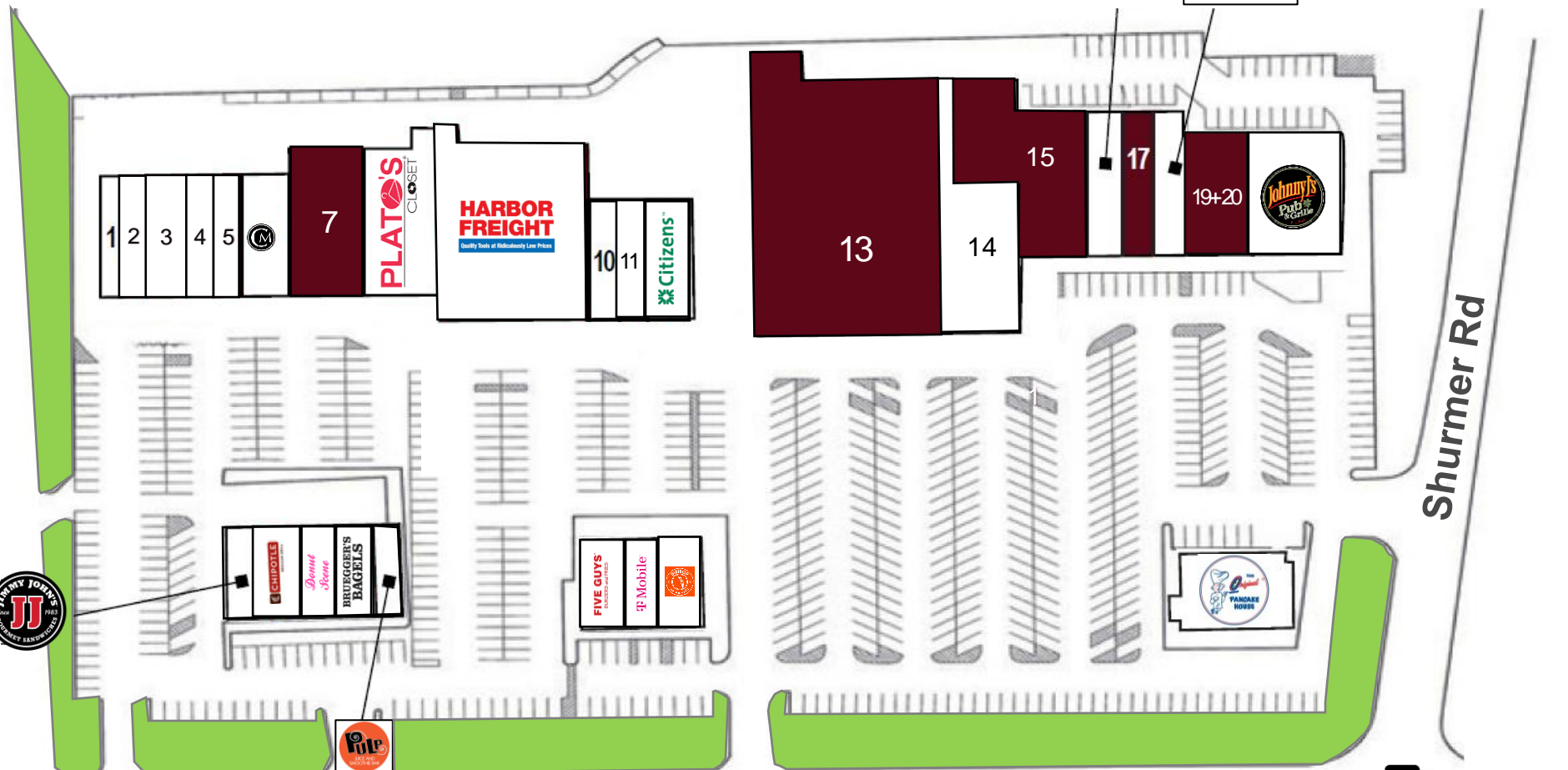

UNIT	TENANT	SIZE	UNIT	TENANT	SIZE
1	White Flower Cake Shop	- 1,500 SF	16	Hudec Dental	- 3,078 SF
2	WeBuyAnyCar	- 1,500 SF	17	AVAILABLE	- 2,400 SF
3	Mariner Finance	- 3,000 SF	18	Paint with a Twist	- 2,400 SF
4	Ground Zero Comics	- 2,000 SF	19, 20	AVAILABLE	- 4,500 SF (Divis.)
5	Clothes Mentor	- 1,500 SF	21	Johnny J's Pub	- 6,000 SF
6	Clothes Mentor	- 3,500 SF	22	Jimmy Johns	- 1,375 SF
7	AVAIL (RESTAURANT)	- 6,000 SF	23	Chipotle Mexican Grill	- 2,325 SF
8	Plato's Closet	- 6,000 SF	24	Donut Scene	- 1,875 SF
9	Harbor Freight	- 15,336 SF	25	Bruegger's Bagels	- 1,875 SF
10	Maggie & Ellie's	- 2,000 SF	26	Pulp Smoothie & Juice Bar	- 1,425 SF
11	Dr. Comfort Spa	- 2,000 SF	27	Five Guys	- 2,400 SF
12	Citizen's Bank	- 3,000 SF	28	T-Mobile	- 1,500 SF
13	AVAILABLE	- 29,808 SF	29	Bibibop	- 2,250 SF
14	Spry Health	- 4,800 SF	30	Original Pancake House	- 4,829 SF
15	AVAILABLE	- 8,987 SF			



Pearl Rd

22,702 VPD



DEMOS	3 Miles	5 Miles	7 Miles
Population	49,689	128,406	223,064
Households	20,024	51,770	90,583
Average H.H. Income	\$99,108	\$88,310	\$83,019



FLOOR PLAN

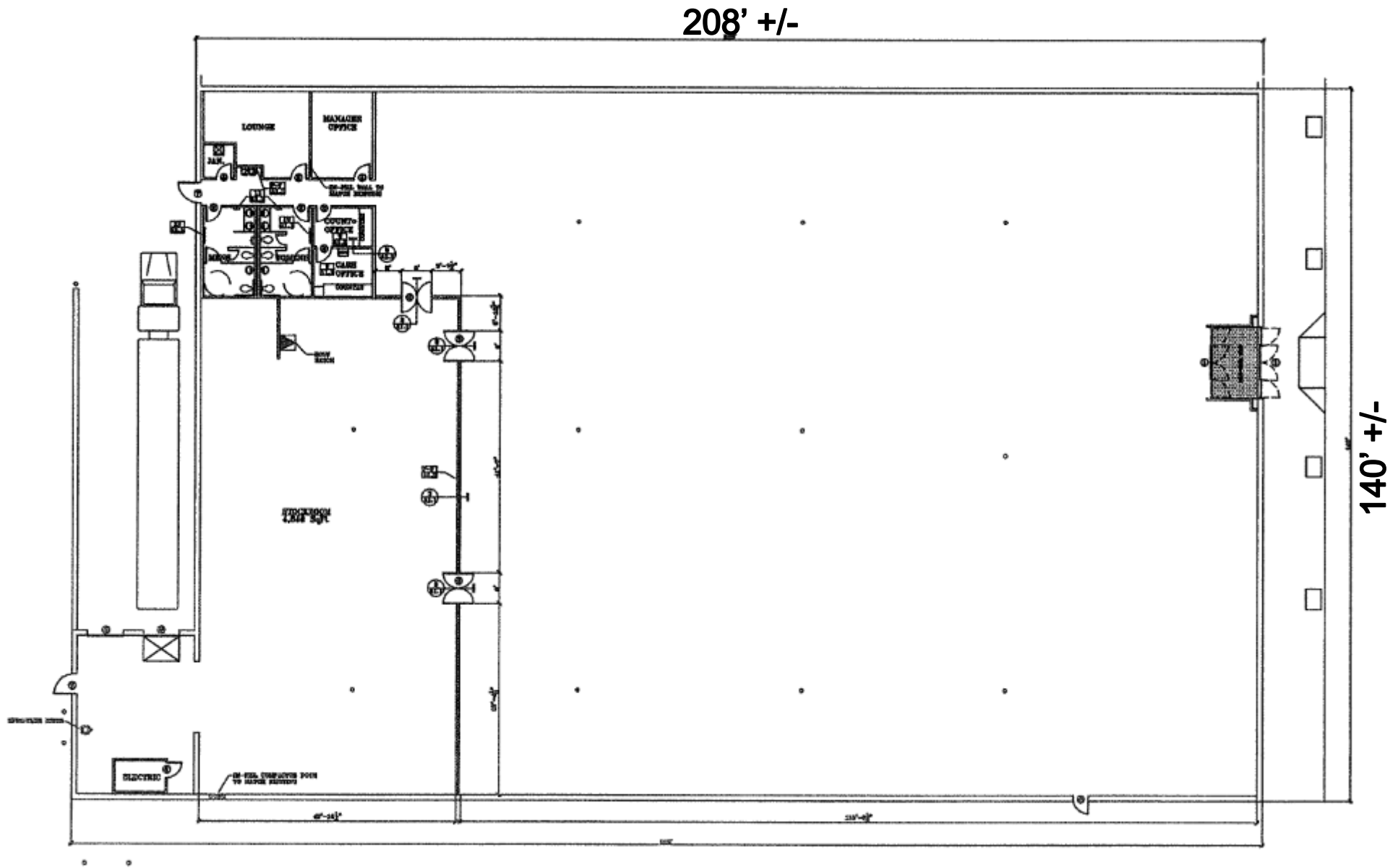

PHOTOS

EXTERIOR



PHOTOS

EXTERIOR



TRADE AERIAL



- Visit

FOR MORE INFO

Michael DiFranco



📞 216 736 8000

✉ michael@difrancoCRE.com

🌐 www.difrancoCRE.com